

Property Record Card

Property	
Property SBL	12021 0013
Address	32 NEWTONVILLE AVE
Tax Bill Number	2206540
Land Use	3040
Land Use Description	NURSING HM
Lot Size	14,258 sq ft
Zoning	SR3
Map ID	034SW
ID	12021 0013

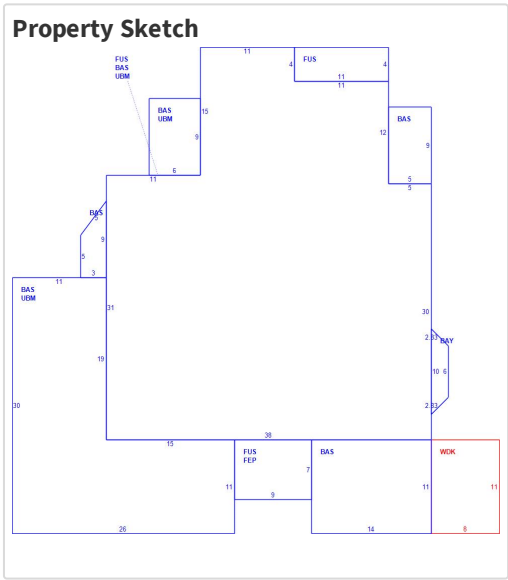
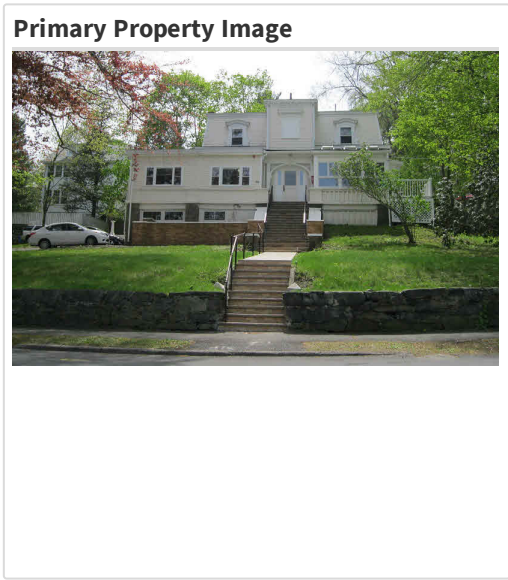

Current Owner	
Owner Information	DESAI INDIRA UPADHYAY TR
	SHIVA REALTY TRUST
	32 NEWTONVILLE AVE
	NEWTON, MA 02458

Sale History	
Owner	DESAI INDIRA UPADHYAY TR
Co Owner	SHIVA REALTY TRUST
Sale Date	1988-04-01
Sale Price	\$100,000
Legal Reference	19248/514

Assessment History	
Assessed Value	Fiscal Year
\$957,900	2021
\$904,700	2020
\$899,900	2019
\$863,600	2018

Visit History	
Visit Date	Type
2018-05-07	Other
2014-02-26	Other
2013-08-05	Other

Building General	
Building Style	Nursing ALF
Year Built	1880
Story Height	2
Neighborhood Code	7

Building Exterior	
Deck Area	88
Porch Area	sq ft
Enclosed Porch Area	63

Building Interior	
Rooms	20
Bedrooms	18
Baths	4
Heat Type	Steam
Fuel Type	Typical
Air Conditioning	None
Building Size	3,810 sq ft
Unfinished Attic Area	sq ft
Basement Area	2,008
Finished Basement Area	sq ft

Building Area	
Building Type	COMMERCIAL
Gross Building Area	5,969 sq ft
Effective Area	4,319 sq ft
Building Area	3,810 sq ft

Condominium	
Number of Units	18

Detached Structures

Apartments